

Index No. J-9

CERTIFICATE OF LOCATION OF GOVERNMENT CORNER

NORTHEAST Corner of Section 17, Township 108 N, Range 41 W
5th Principal Meridian, State of Minnesota, County of MURRAY

At the corner location shown on the sketch:

On 12/16/03 found a "T" BAR, DOWN 0.3'
DATE

left monument as found, lowered monument, removed monument (explain)

On _____ Placed a _____
DATE

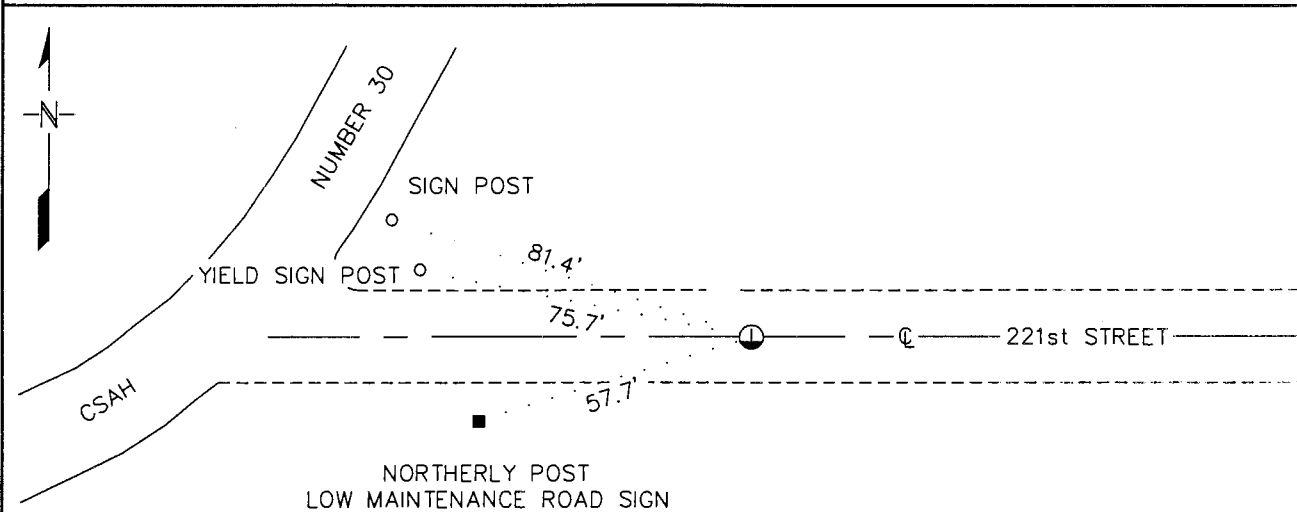

MURRAY COUNTY
 COORDINATE SYSTEM
 NAD 1983 1986 ADJ.
 N = 216324.463
 E = 495388.491

Statement of evidence for this corner location is on back of this page.

JUNE 2004
WAS00473.00.00.01

I certify that this document was researched and prepared by me or under my direct supervision.

SIGNATURE Russ W. Sheppard DATE 6-29-04 License Number 17003

Title: Land Surveyor Professional Engineer County Surveyor County Engineer

The DNR Division of Lands and Minerals contacted the following for survey information:

Minnesota Secretary of State's Office
Murray County Recorder's Office
Murray County Highway Engineer's Office
Zieske Land Surveying, Inc. of Windom
B & G Land Surveys, Inc. of Redwood Falls
Moseng Land Surveying of Marshall
Madsen Land Surveying, Inc. of Fairmont

1854 U.S. General Land Office notes, obtained from the Secretary of State's Office, show the corner in a lake so a monument was NOT set to mark its location.

1958 Ties to government corners, obtained from the County Highway Engineer's Office, show a concrete monument at corner, but does not indicate if it was found or set. The following ties are shown to corner:

nail and cap in fence post, southwest, 49.9 feet
nail and cap in fence post, west, 37.9 feet

1967 August 18, the DNR Survey Unit found a stone with a "X" on top, 1 foot above the ground and 0.5 of a foot below the present water surface. The following is noted about corner:

no one knows how the stone got set, but it has been there a number of years – original survey shows this corner in lake

2002 July 18, A Certificate of Location of Government Corner for the Southwest Corner of Section 9, obtained from B & G Land Surveys, Inc., and signed by Gerald Vickerman, LS 12237, shows that a stone was found down 4 feet near the level of old lake reeds as indicated by old records. An iron T bar was set over the stone and the following ties were taken:

on the center line of an east-west road (221 Street)
northerly post of low maintenance sign, west-southwest, 57.7 feet
yield sign post, west-northwest, 75.7 feet
St. sign post, west-northwest, 81.4 feet

The following Statement of Evidence is written about the corner:

Original survey did not set this corner but did position its location by offset.

May 1931 survey by F.A. Marsh established this corner on line of NW Cor and W ¼ Cor at 2640 feet from the W ¼ Cor. He placed a 12x12x20 stone for the corner. Lake apparently had receded.

Appears to have been used again in 1934 with ties taken. Ties gone.

On 7-18-2002 we dug for SW Cor Sec 9 at center line of gravel road. Dug thru 9"-10" of rocks and gravel then thru black dirt for 3 + feet. Found a large stone at 4 feet down at a point level with crushed reeds. Top of stone just above reed level, bottom unknown as water was seeping into hole

Accepted as corner stone, tied out and set an iron T bar over stone at ties.

2002 June A Certificate of Survey in Section 9, obtained from B & G Land Surveys, Inc., and
03 July signed by Gerald Vickerman, LS 12237, shows that a section corner was found at corner.
The corner is shown:
2644.99 feet from the west quarter corner of Section 9
2650.34 feet from the south quarter corner of Section 9

2003 December 16, the DNR Division of Lands and Minerals found a "T" bar down 0.3 of a foot at corner. Searched for and found record ties as shown on sketch of reference ties.

Accept the "T" bar, which was set over a stone, as the location of the corner as established in 1931.